

4 Rafter Foot  
1" = 1'-0"

5 ONE GIRT (WITH TENON) @ POST  
1" = 1'-0"

6 ONE GIRT (WITH BOTTOM SPLINE) @ POST  
1" = 1'-0"

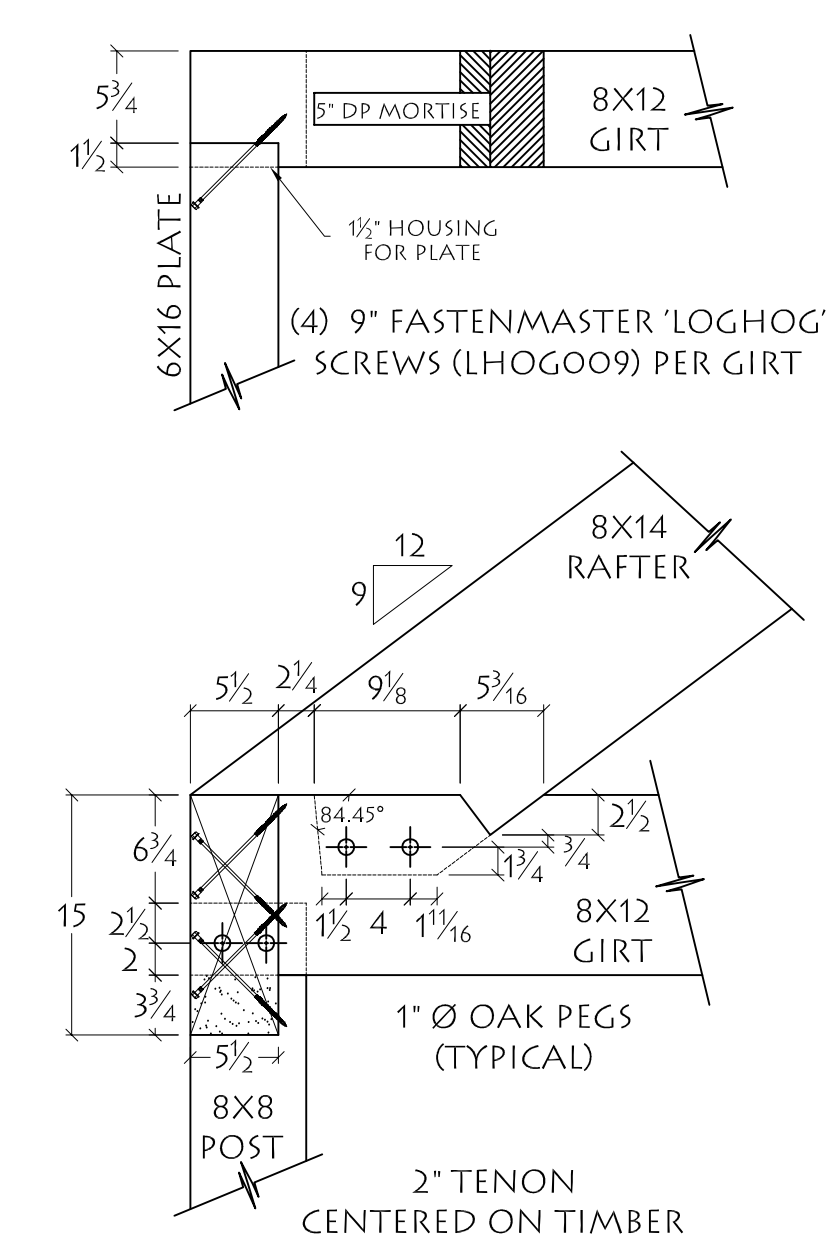
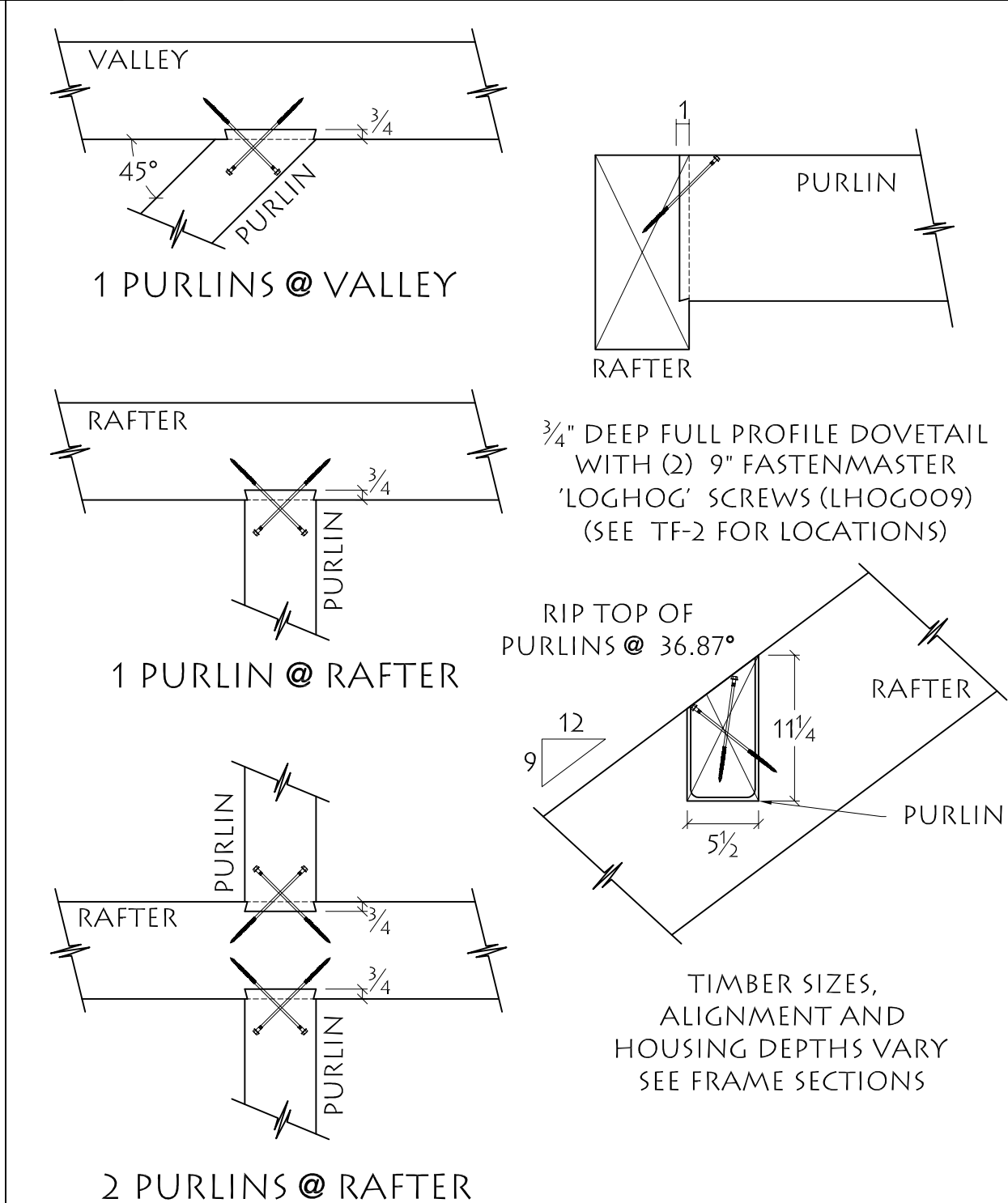
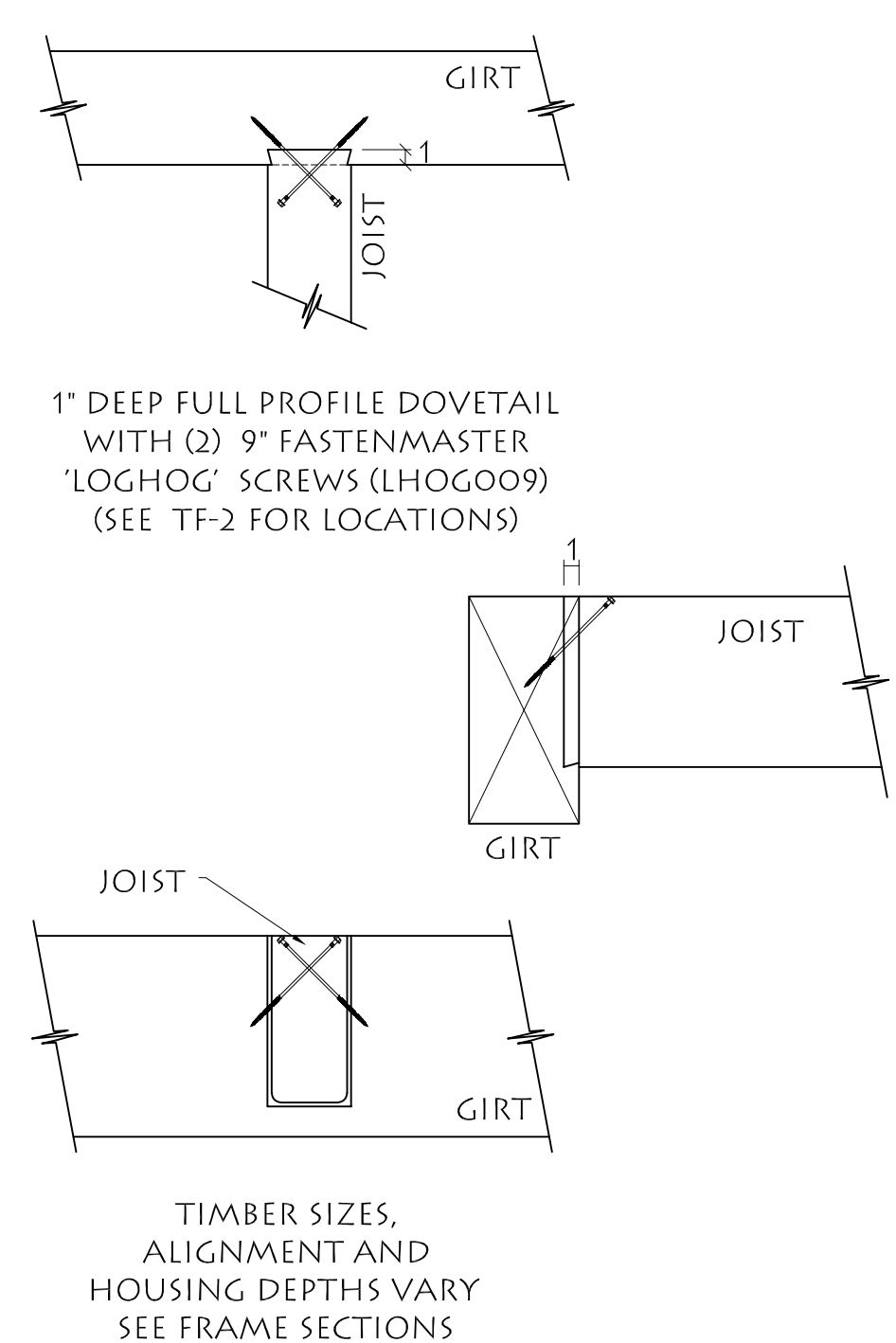

1 JOIST CONNECTIONS  
1" = 1'-0"

2 PURLIN CONNECTIONS  
1" = 1'-0"

3 RAFTER FOOT  
1" = 1'-0"

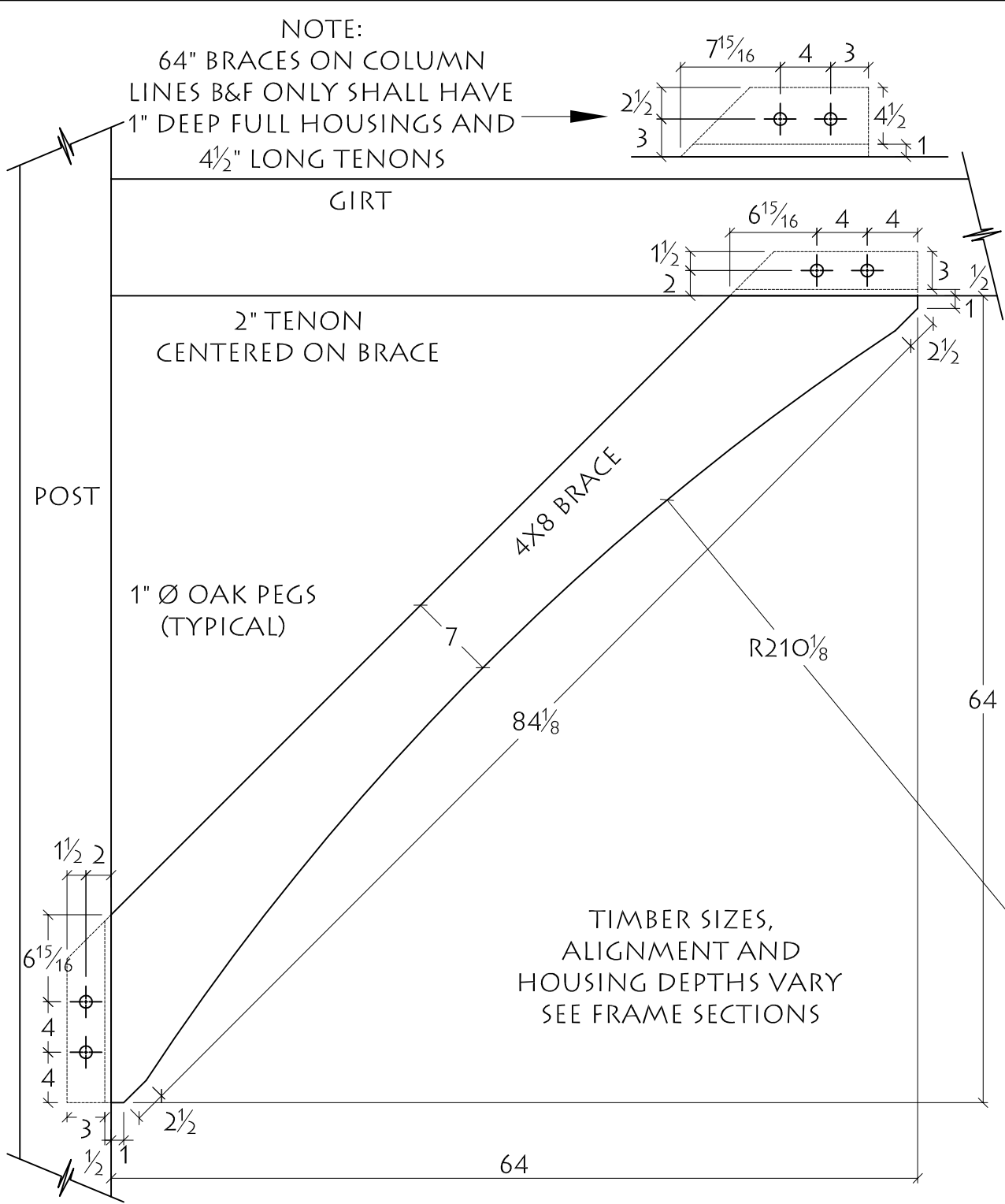

10 64" BRACE  
1" = 1'-0"

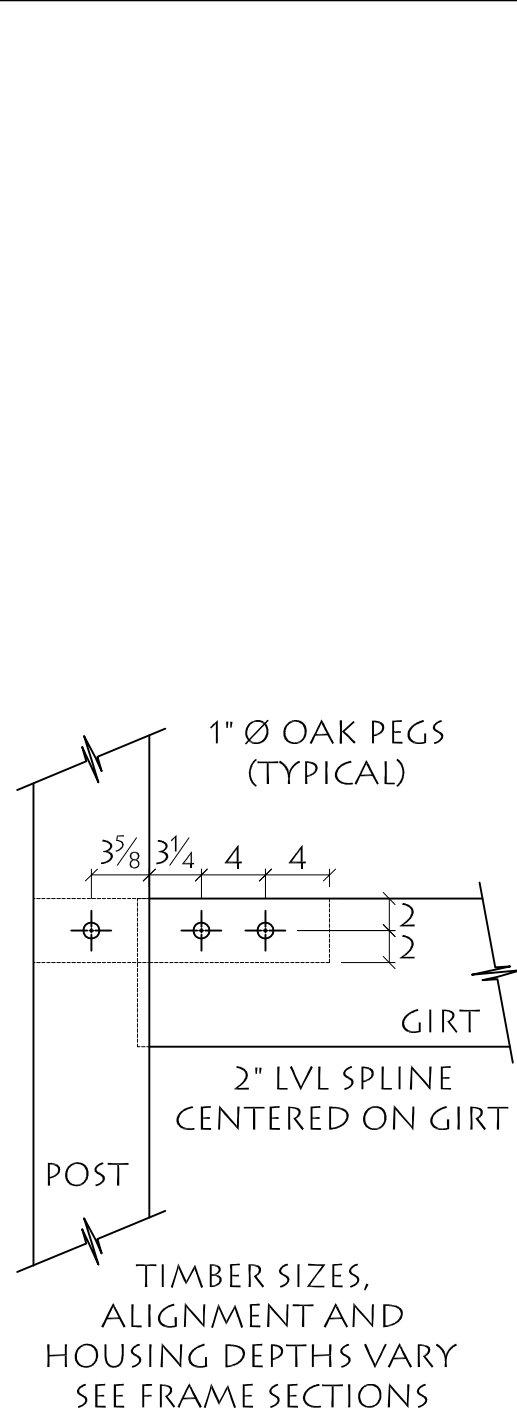

11 ONE GIRT (WITH TOP SPLINE) @ POST  
1" = 1'-0"

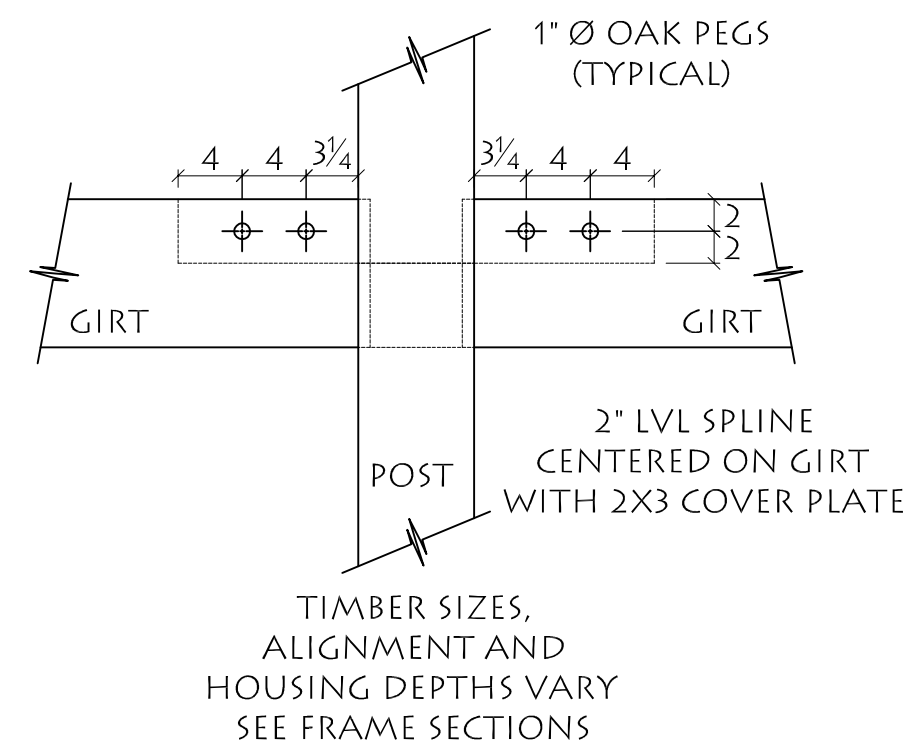

12 TWO GIRTS (WITH TOP SPLINE) @ POST  
1" = 1'-0"

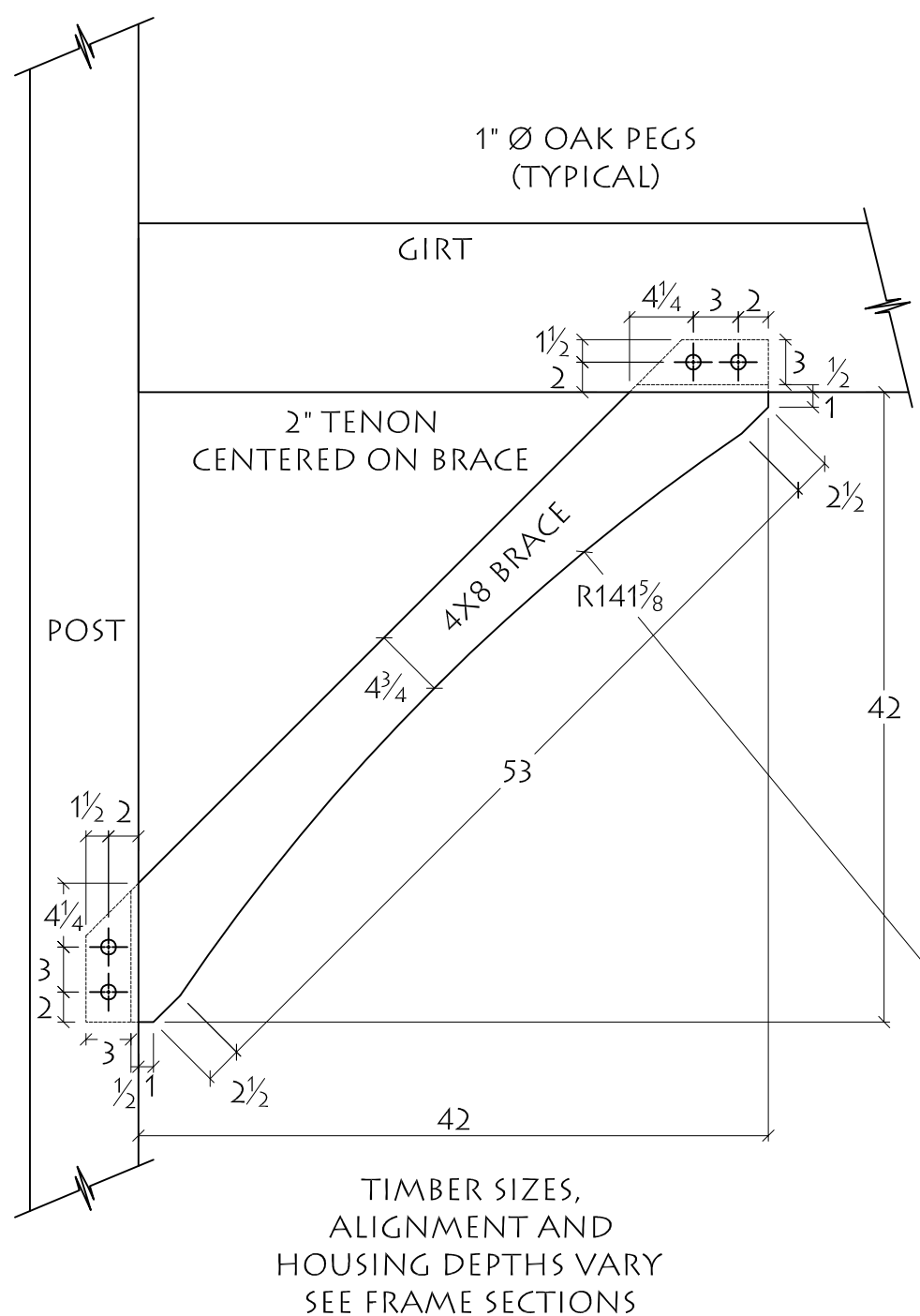

7 42" BRACE  
1" = 1'-0"

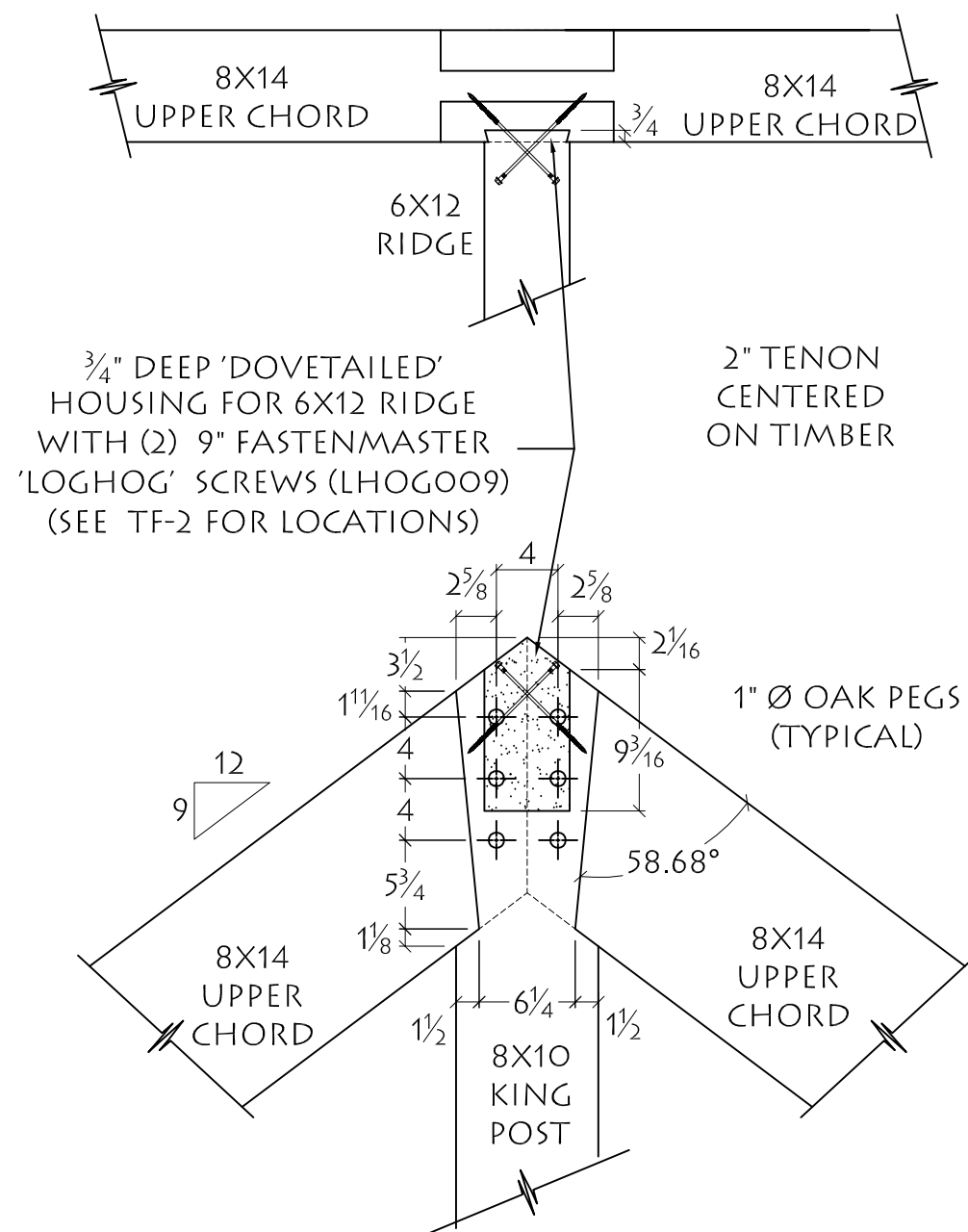

8 RAFTERS & RIDGE @ KING POST  
1" = 1'-0"

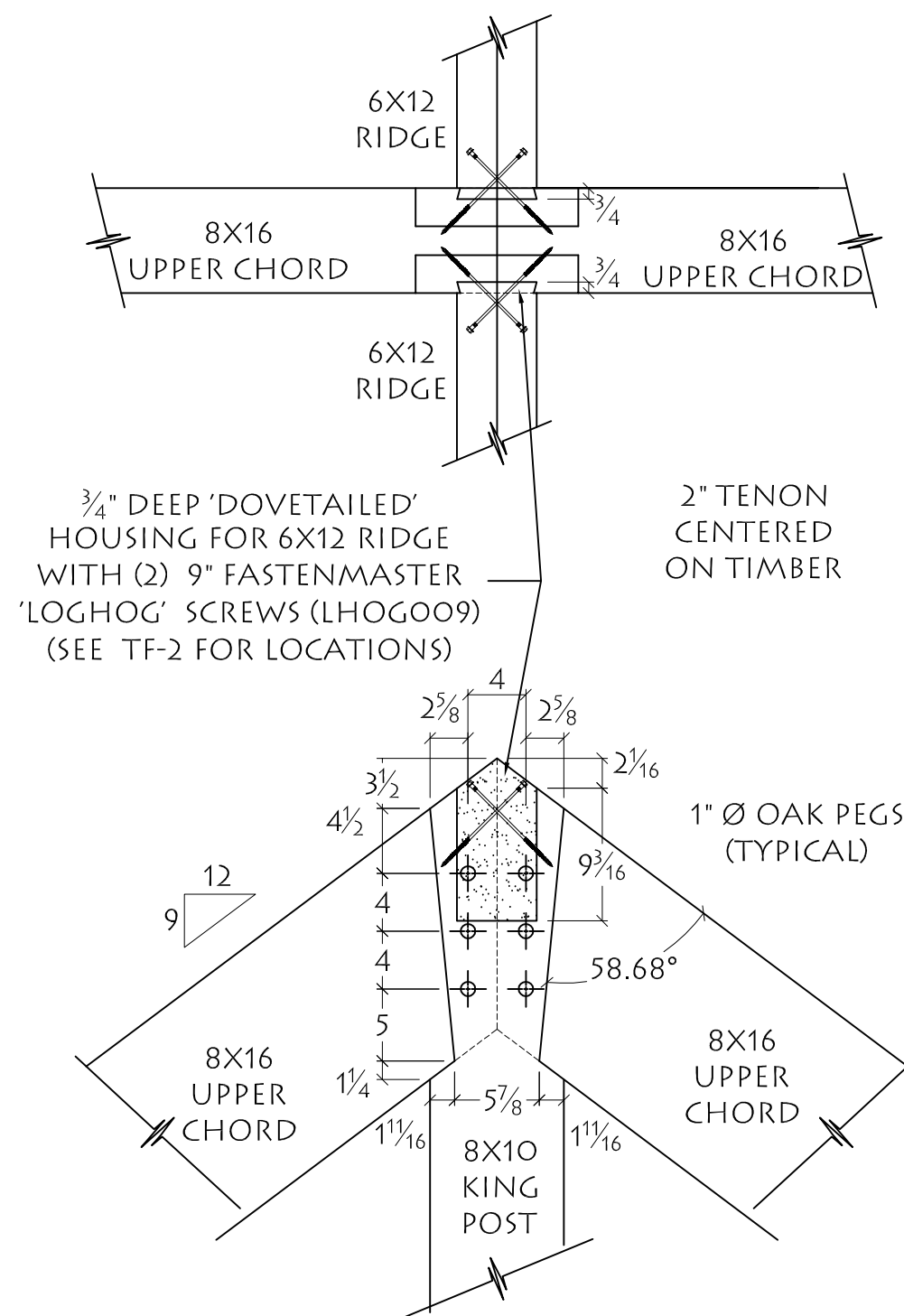

9 RAFTERS & RIDGES @ KING POST  
1" = 1'-0"

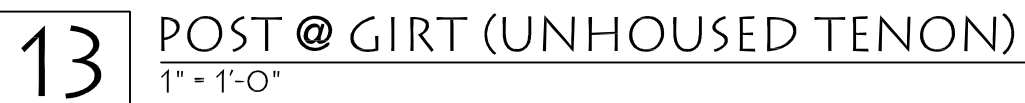

NOTE:

THESE DOCUMENTS  
BEARING THE DATE  
06-05-12 SUPERCEDE  
AND SHALL REPLACE ALL  
PREVIOUSLY SUBMITTED  
DOCUMENTS FOR THIS  
PROJECT

DATE: 06-05-12

DRAWN BY: DFS

SHEET TITLE:

## JOINERY DETAILS

SHEET NUMBER:

D-3

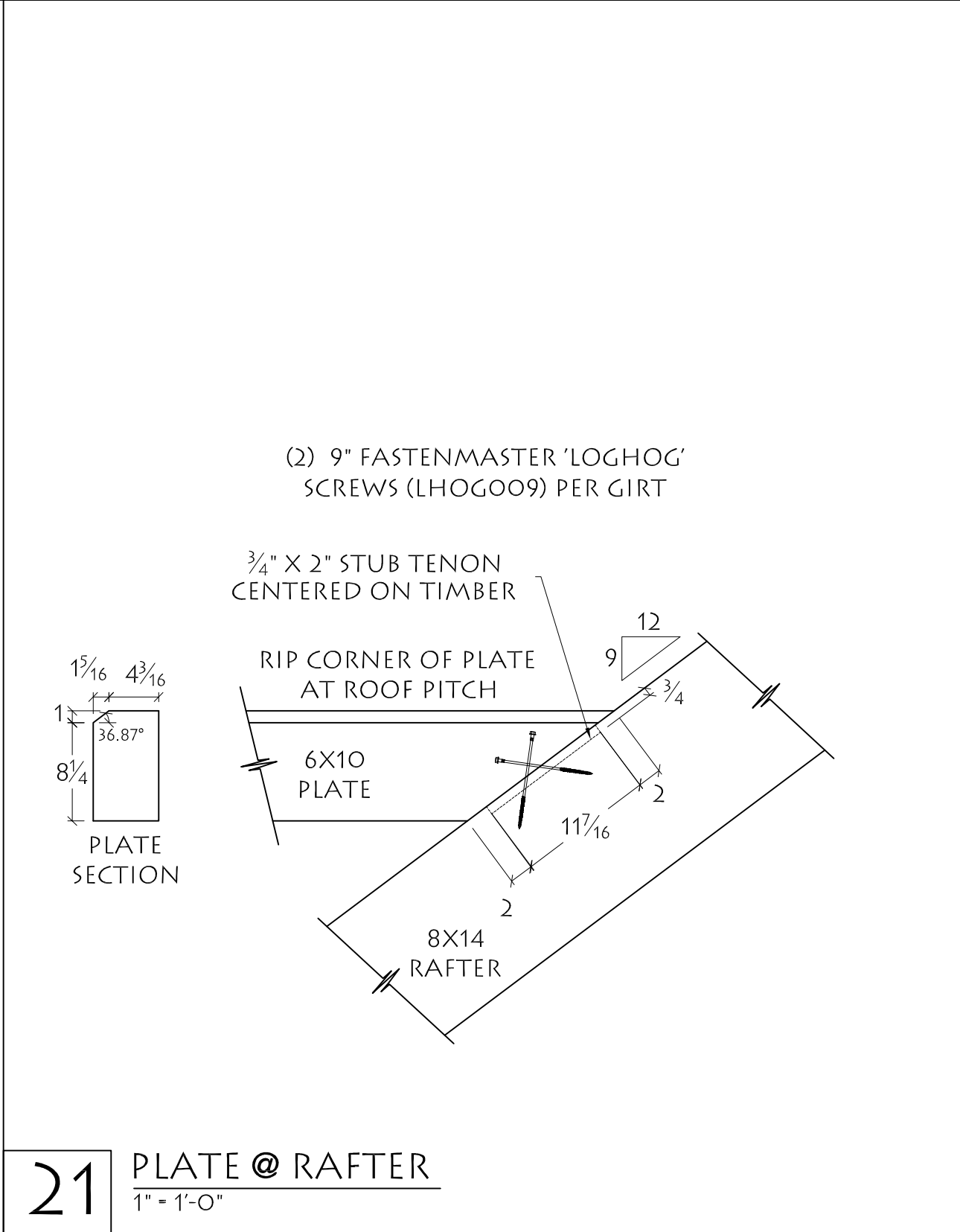
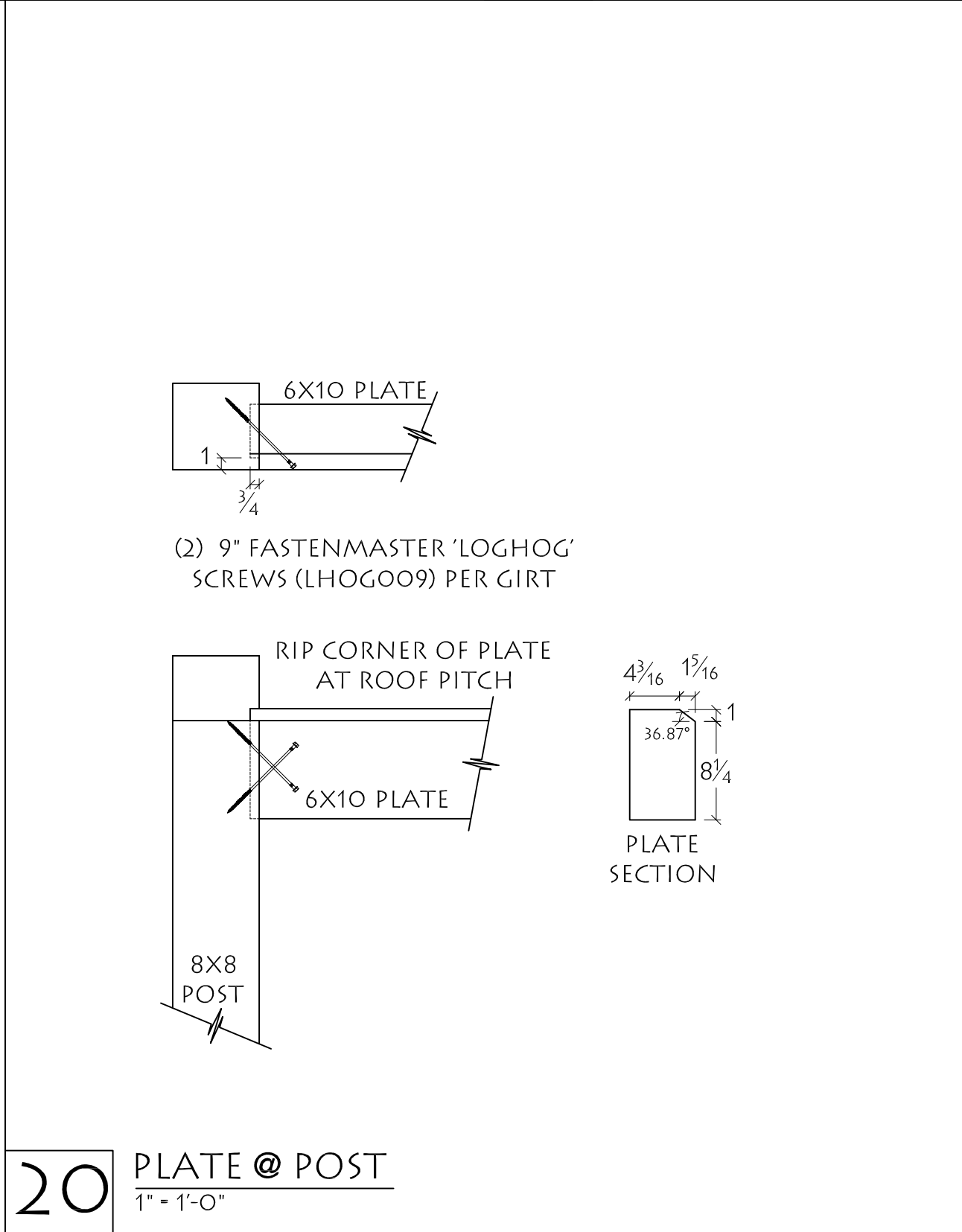
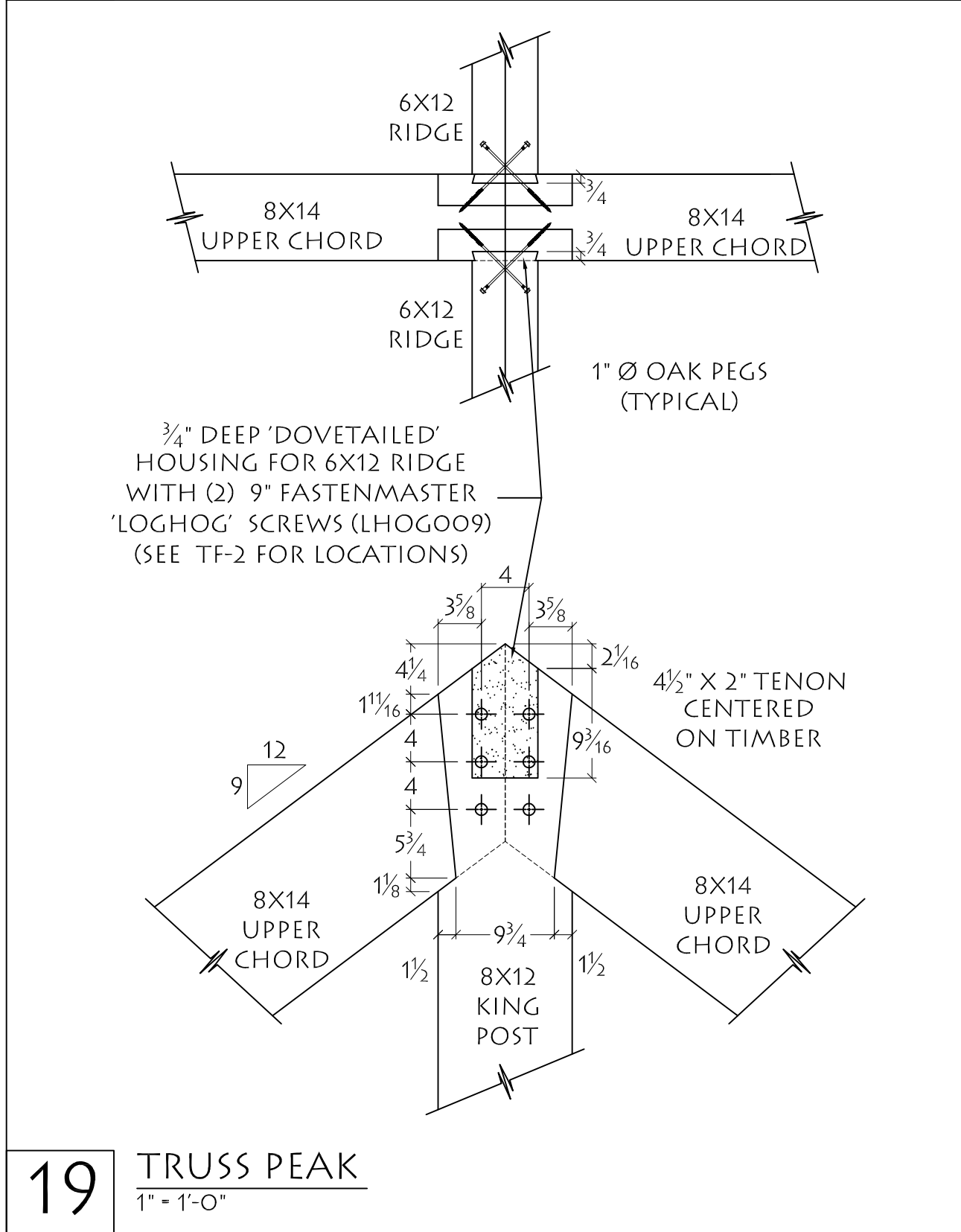
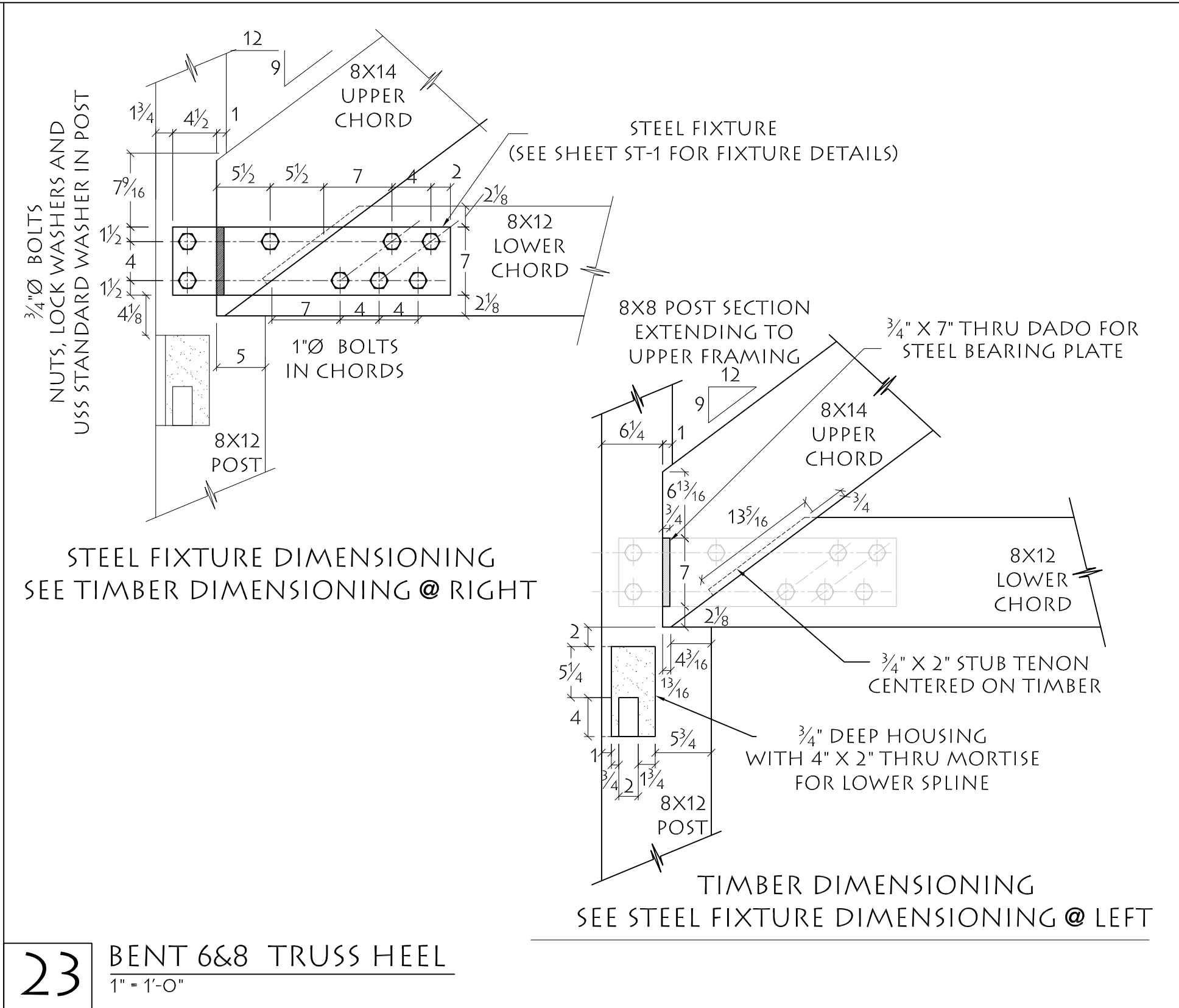
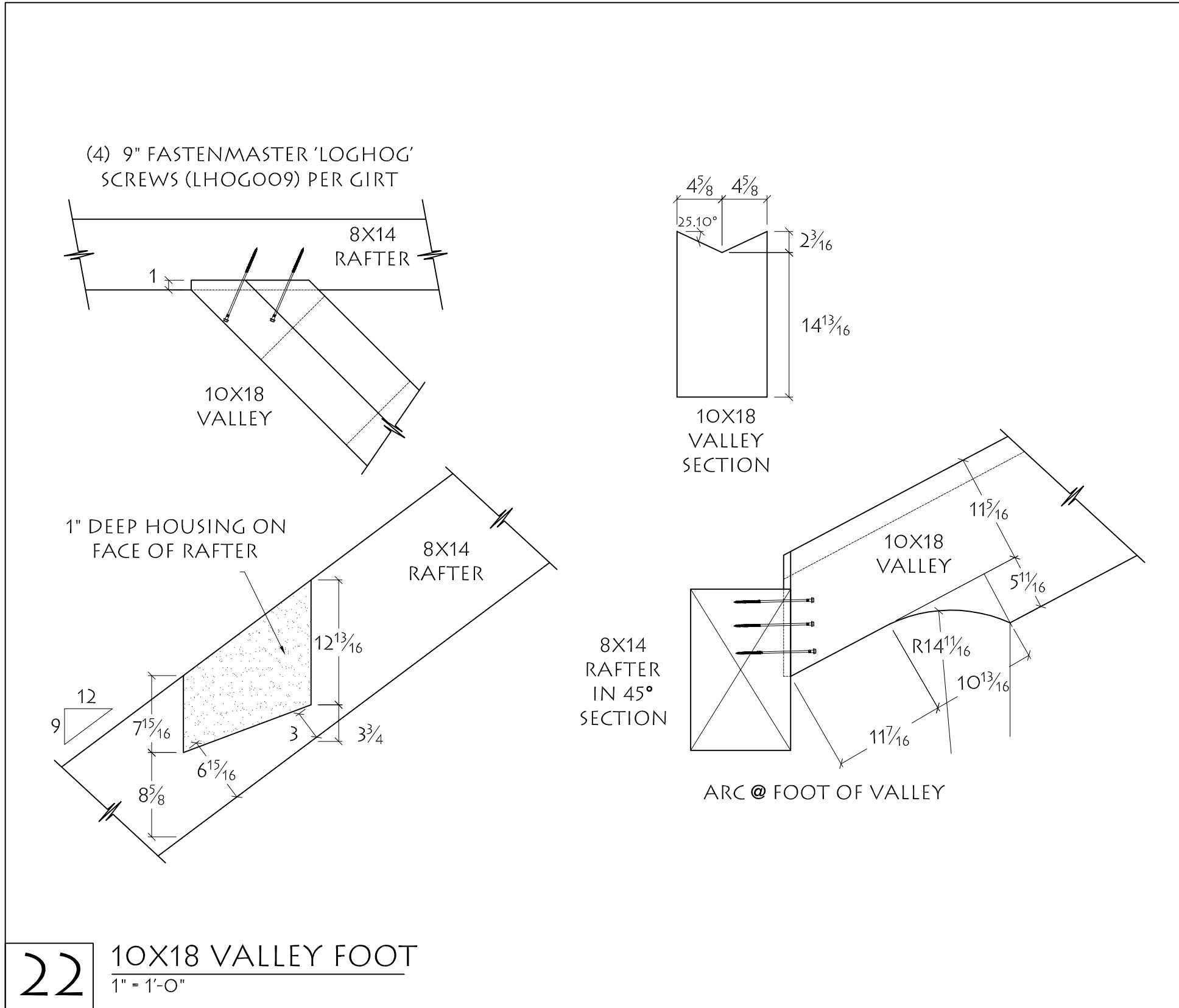

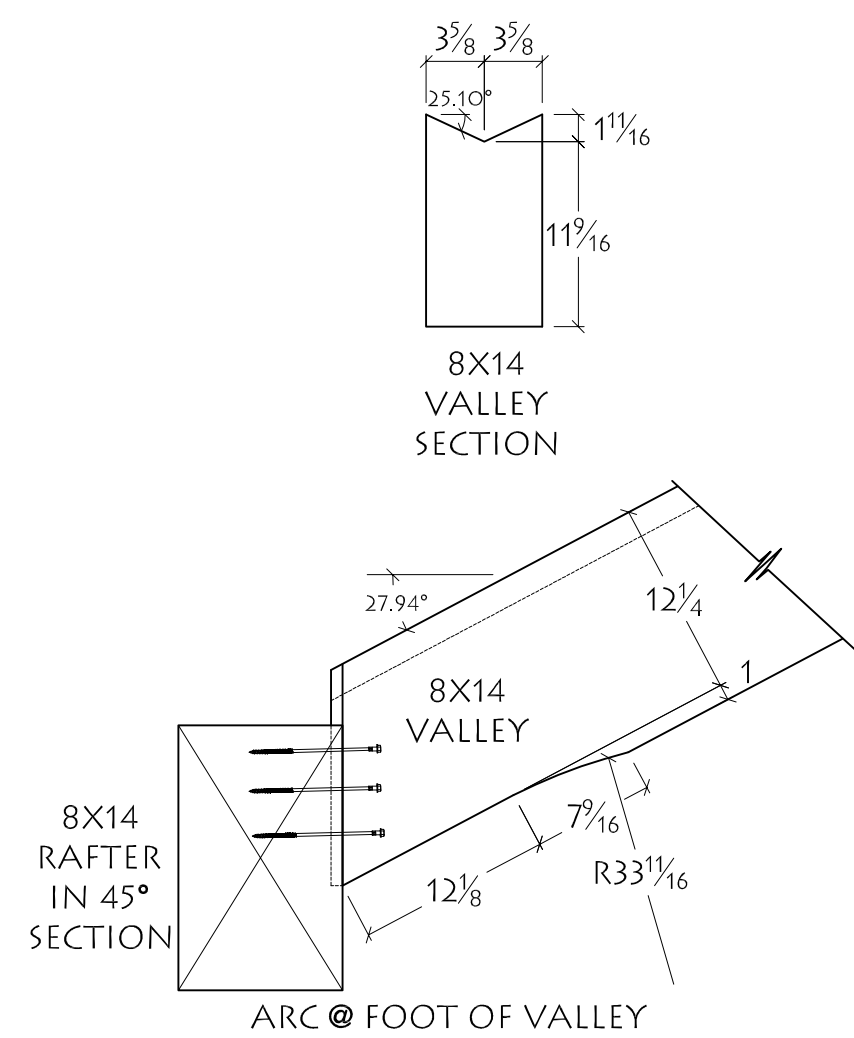
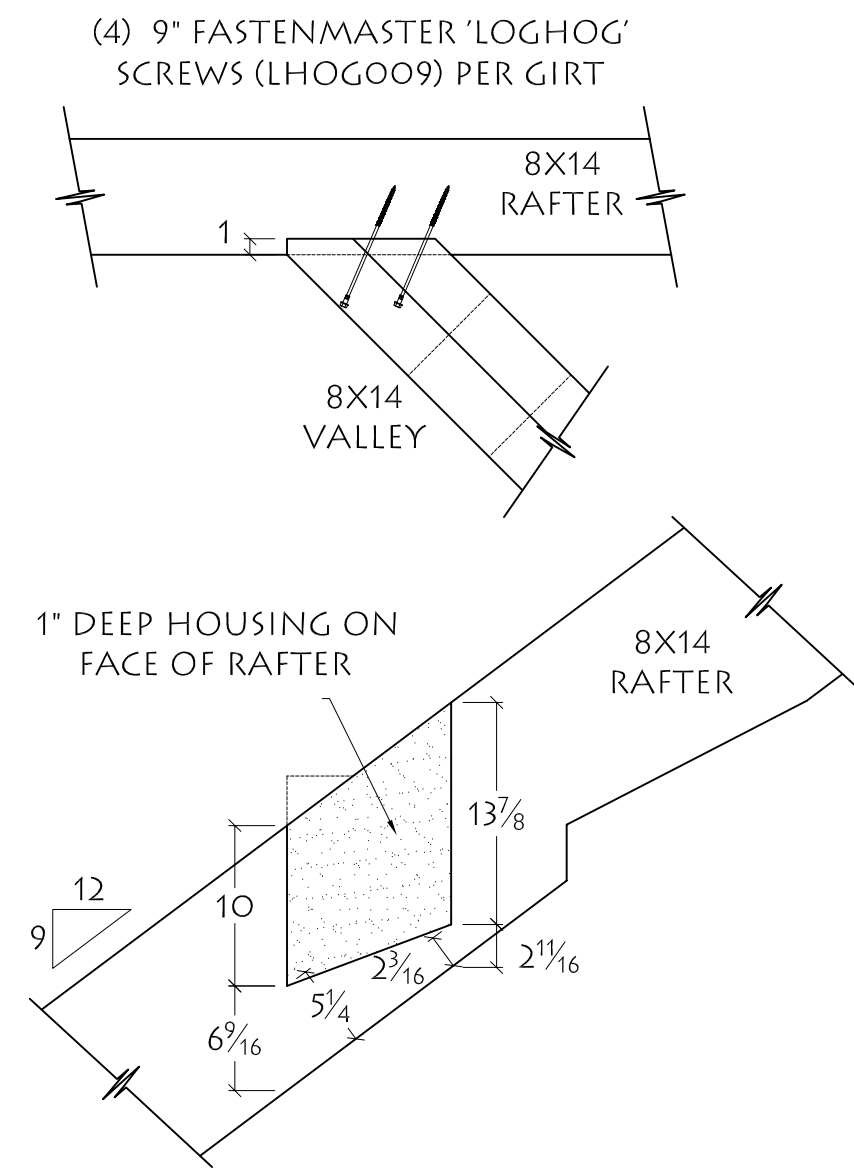

27 8X14 VALLEY FOOT  
1" = 1'-0"

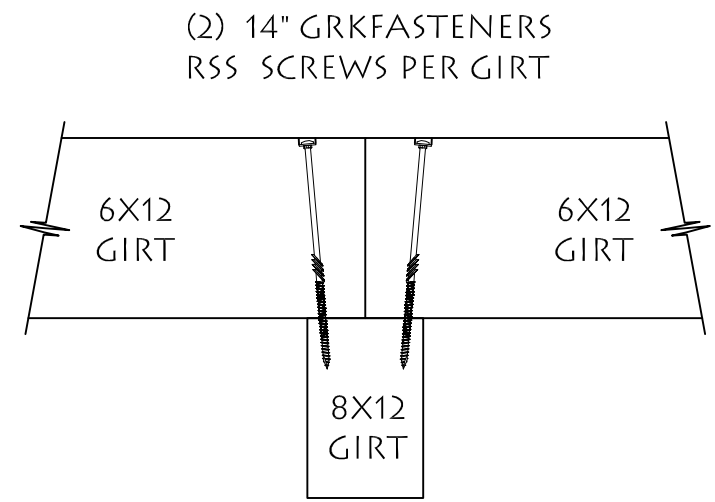

28 TWO RIDGES @ GIRT  
1" = 1'-0"

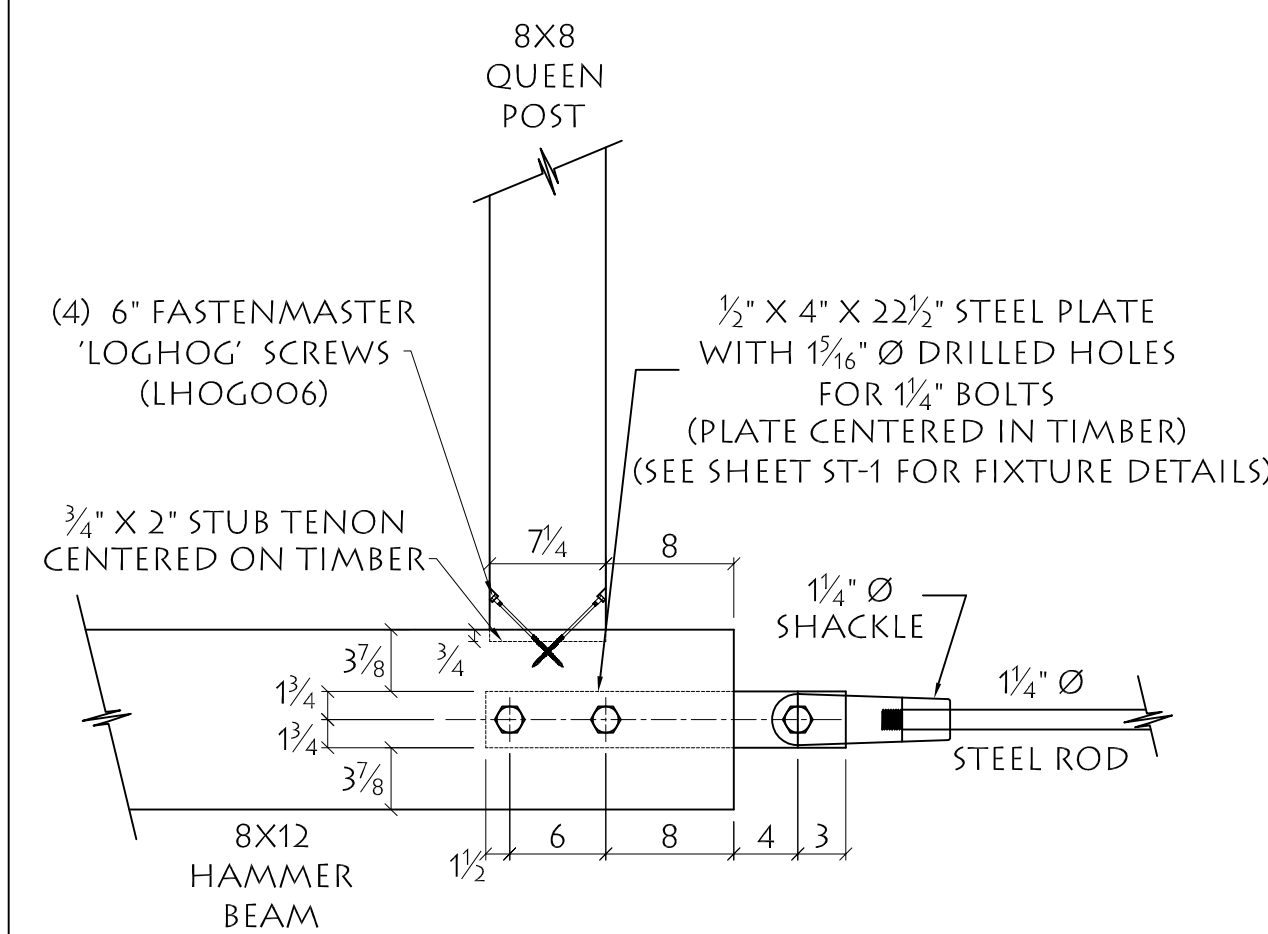

24 QUEEN POST @ HAMMER BEAM  
1" = 1'-0"

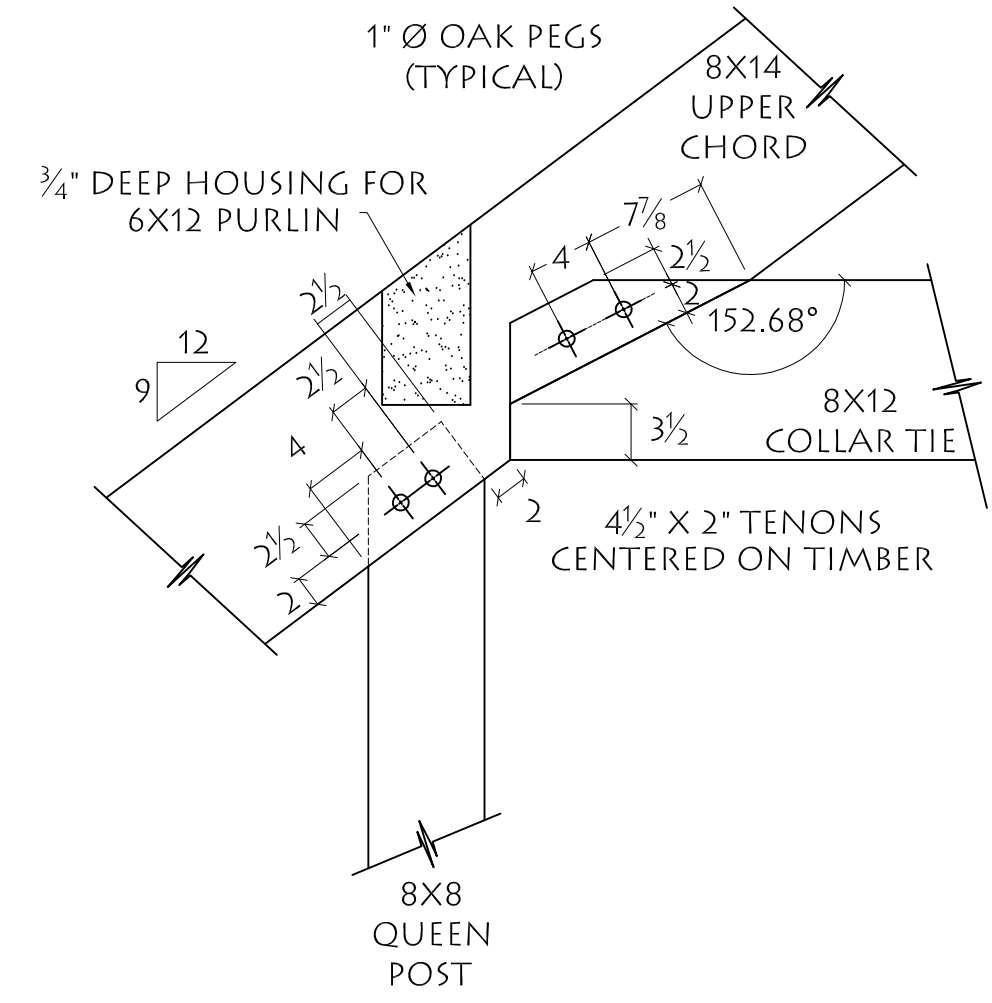

25 QUEEN POST & TIE @ UPPER CHORD  
1" = 1'-0"

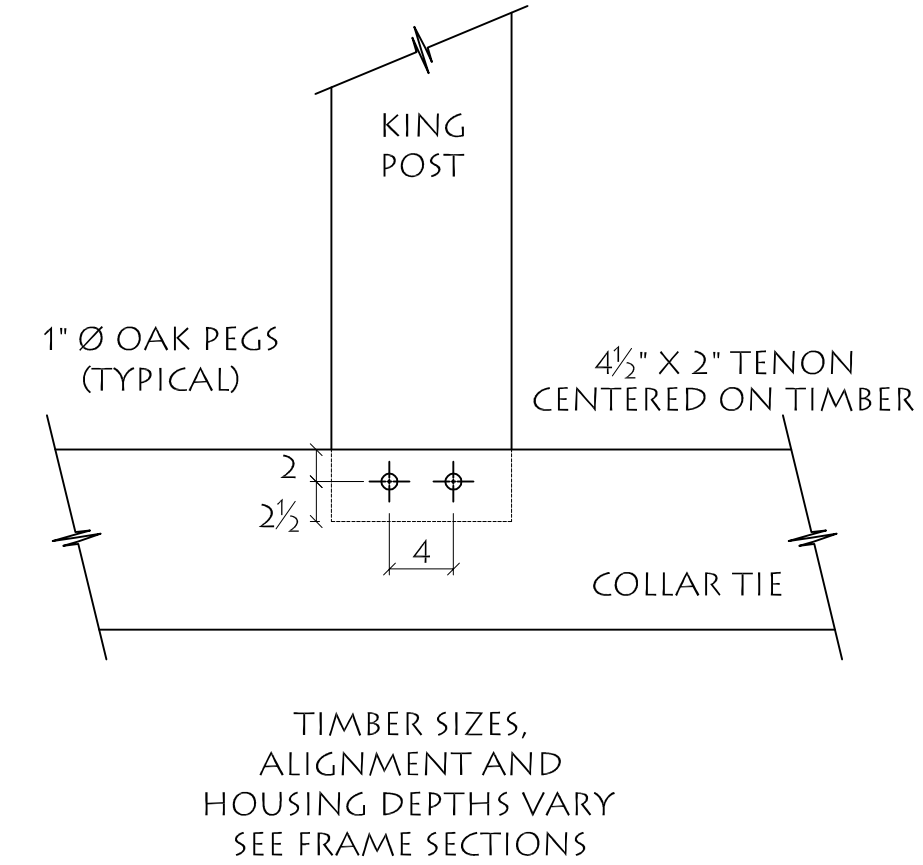

26 KING POST @ COLLAR TIE  
1" = 1'-0"

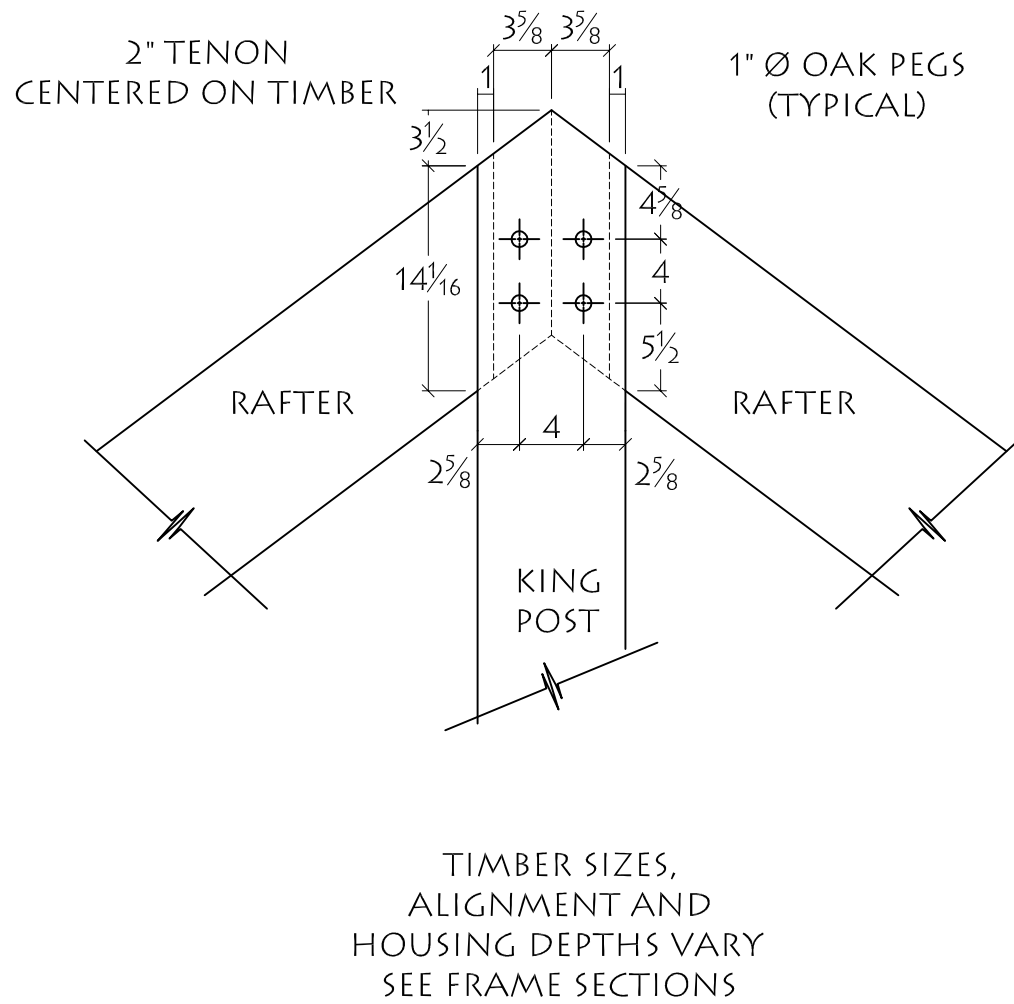

32 RAFTER @ KING POST  
1" = 1'-0"

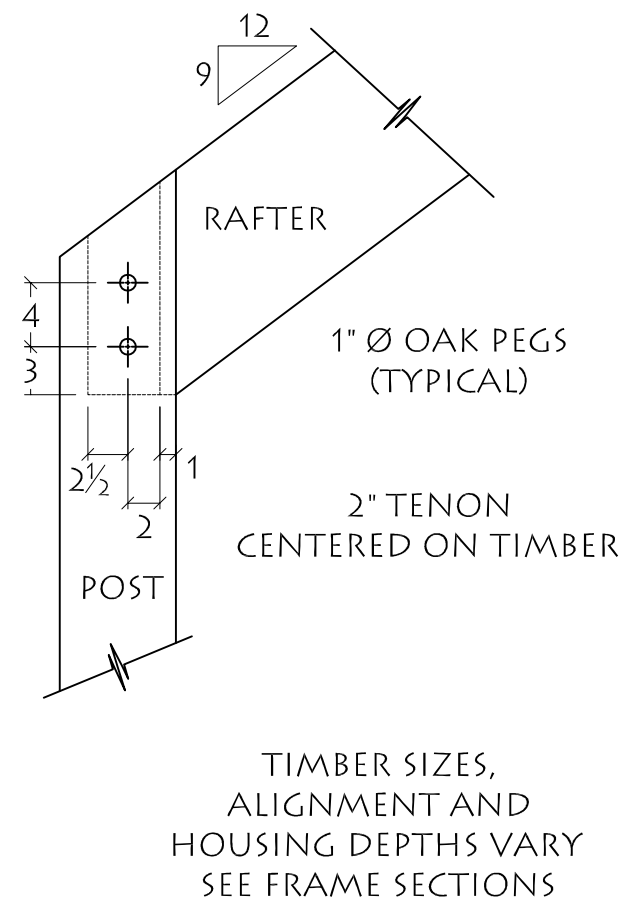

33 RAFTER @ POST  
1" = 1'-0"

SECURE VALLEY AND RIDGE  
TO 8X12 GIRT  
WITH (2) 3/8" X 16" GRK FASTENERS  
RSS SCREWS AS SHOWN

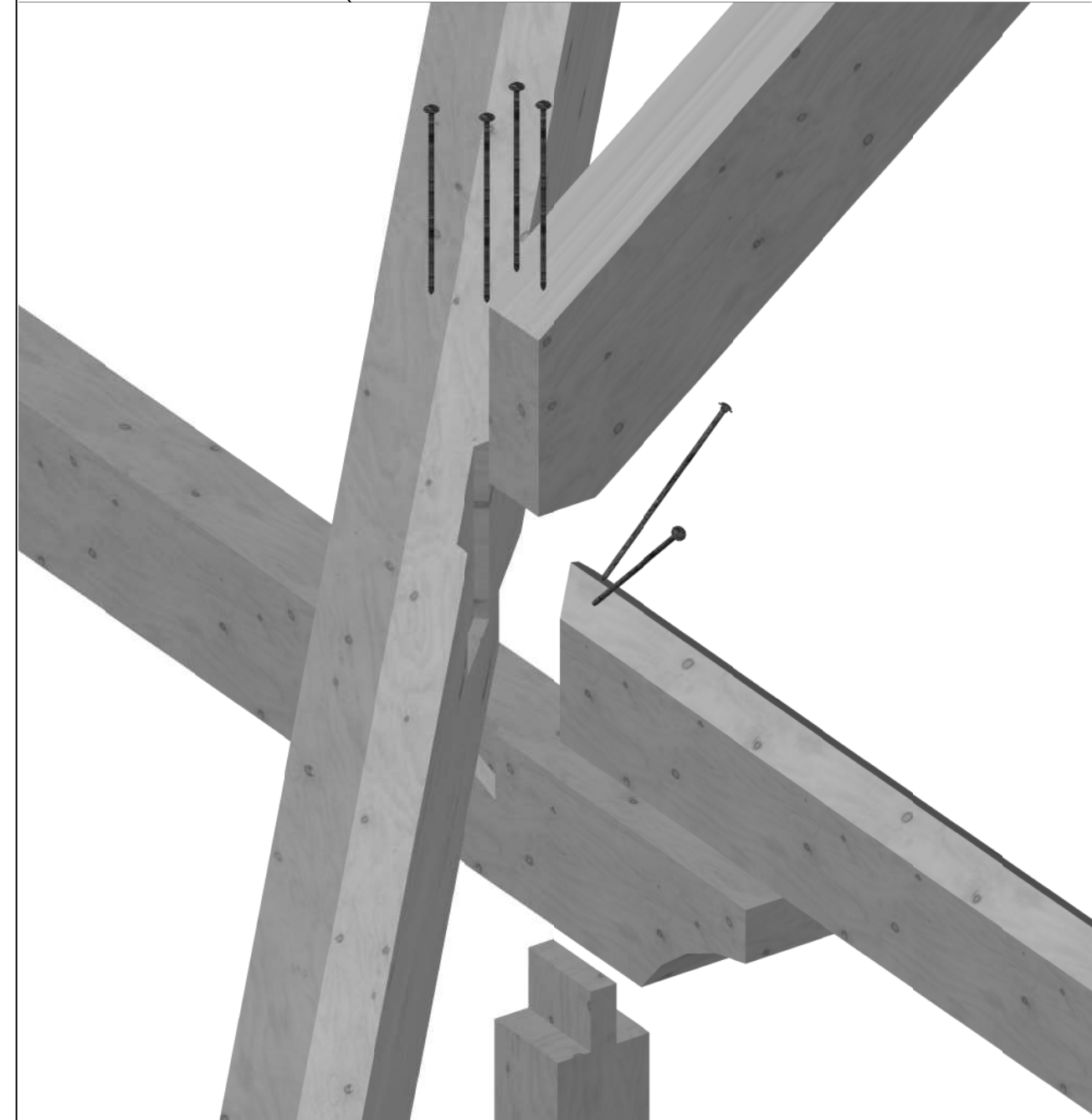

34 VALLEY, RIDGE AND RAFTER @ HEADER  
1" = 1'-0"

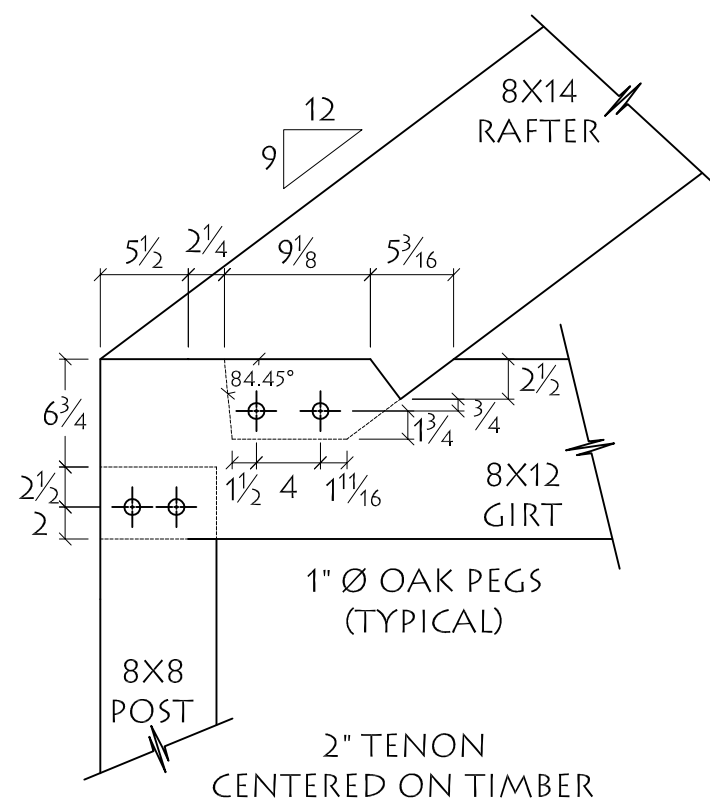

29 BENT 9 RAFTER, TIE AND WALL POST  
1" = 1'-0"

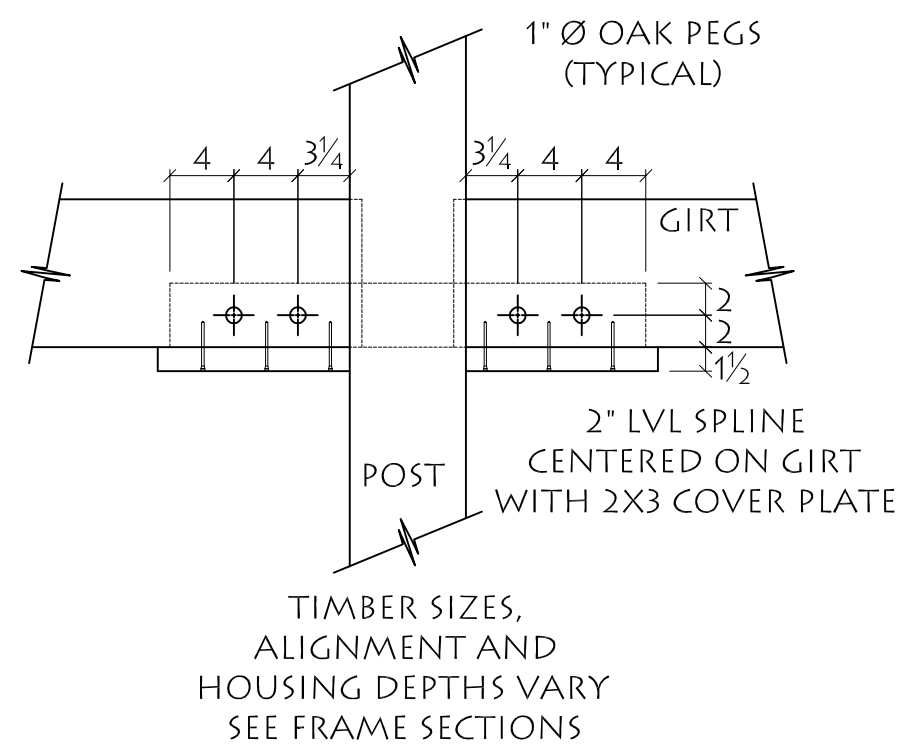

30 TWO GIRTS (WITH BOTTOM SPLINE) @ POST  
1" = 1'-0"

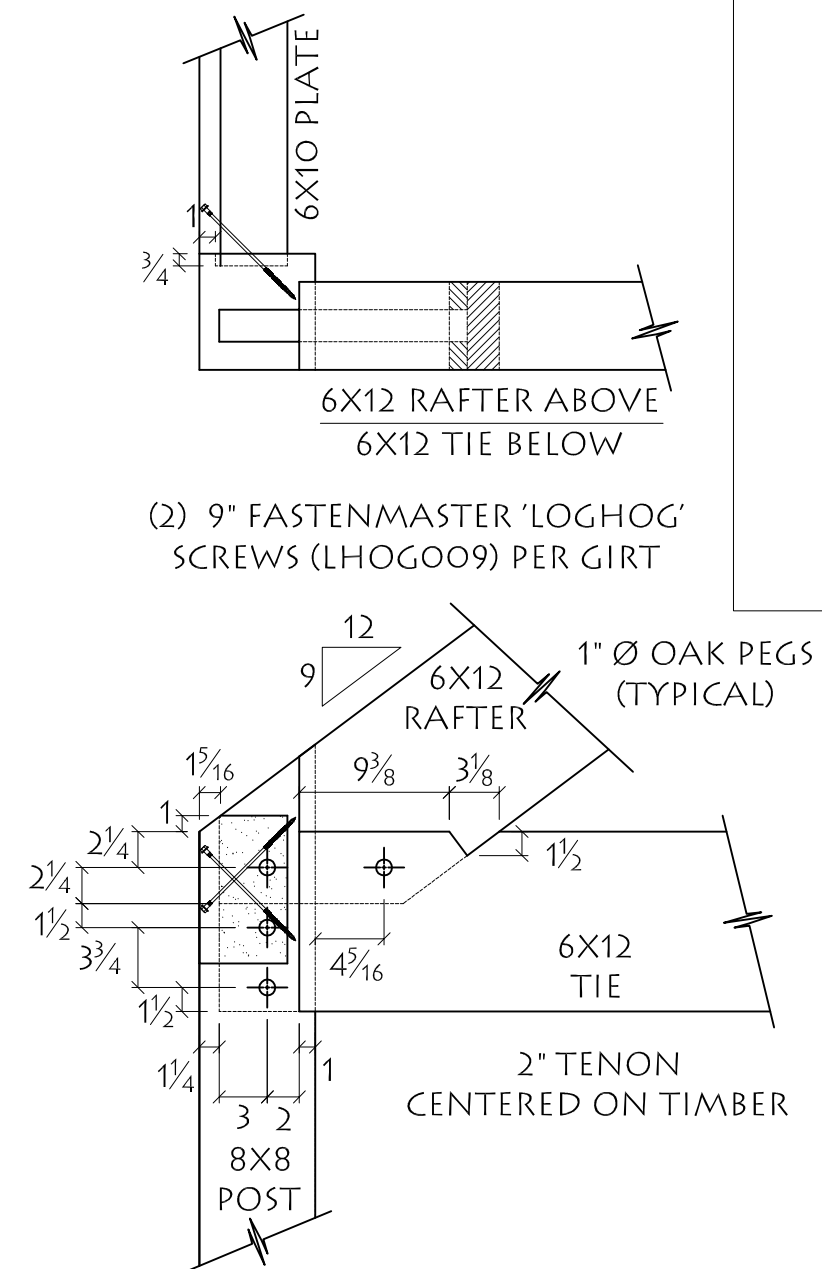

31 POST, RAFTER AND TIE  
1" = 1'-0"

Morning Sky  
Timber Designs,  
LLC  
morningskydesigns.com  
1026 Pine Street  
Perryburg, OH 43551  
ph 419.266.3966

Mid-Atlantic  
TIMBERFRAMES  
14 North Ronks Road, Ronks, PA 17572  
midatlantictimberframes.com  
ph: 717-288-2480

STRUCTURAL ENGINEERS  
D. REMY & CO  
CONSULTANTS  
P.O. Box 1389, Hayesville, NC 28904  
tel: 828.389.1717 email: drn@remy.com

Heavy Timber Frame engineering only  
David R. Hourdequin, PA P.E. #050032E

TIMBER FRAMED GARAGE

DELAWARE COUNTY, PA

REVISIONS

NOTE:  
THESE DOCUMENTS  
BEARING THE DATE  
06-05-12 SUPERCEDE  
AND SHALL REPLACE ALL  
PREVIOUSLY SUBMITTED  
DOCUMENTS FOR THIS  
PROJECT

DATE: 06-05-12

DRAWN BY: DFS

SHEET TITLE:  
JOINERY  
DETAILS

SHEET NUMBER:

D-6



TIMBER FRAMED GARAGE

DELAWARE COUNTY, PA

**# REVISIONS #**

**NOTE:**  
THESE DOCUMENTS  
BEARING THE DATE  
06-05-12 SUPERCEDE  
AND SHALL REPLACE ALL  
PREVIOUSLY SUBMITTED  
DOCUMENTS FOR THIS  
PROJECT

DATE: 06-05-12

DRAWN BY: DFS

SHEET TITLE:  
JOINERY DETAILS

SHEET NUMBER:

D-7

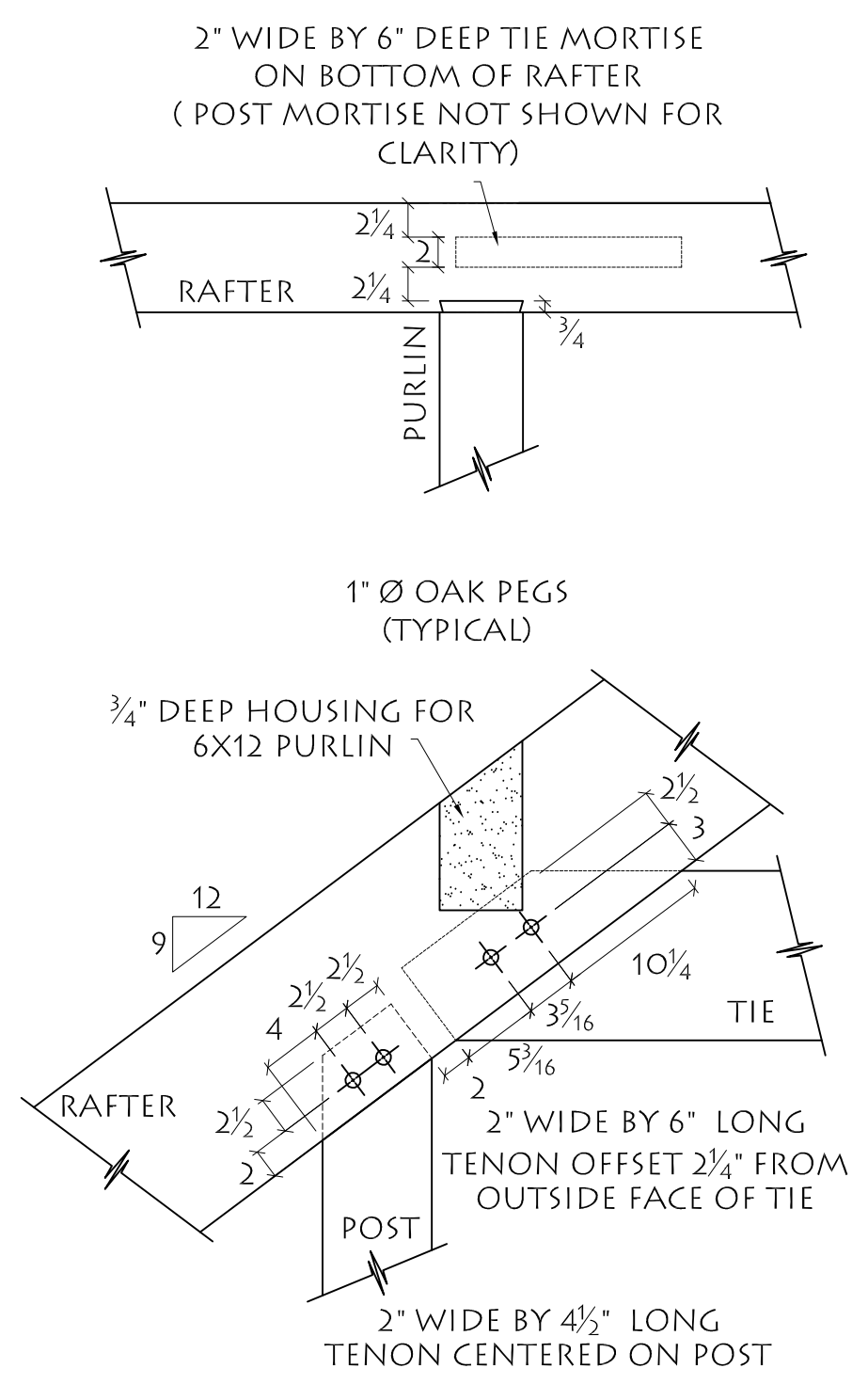

38 TIE & POST @ RAFTER  
1" = 1'-0"

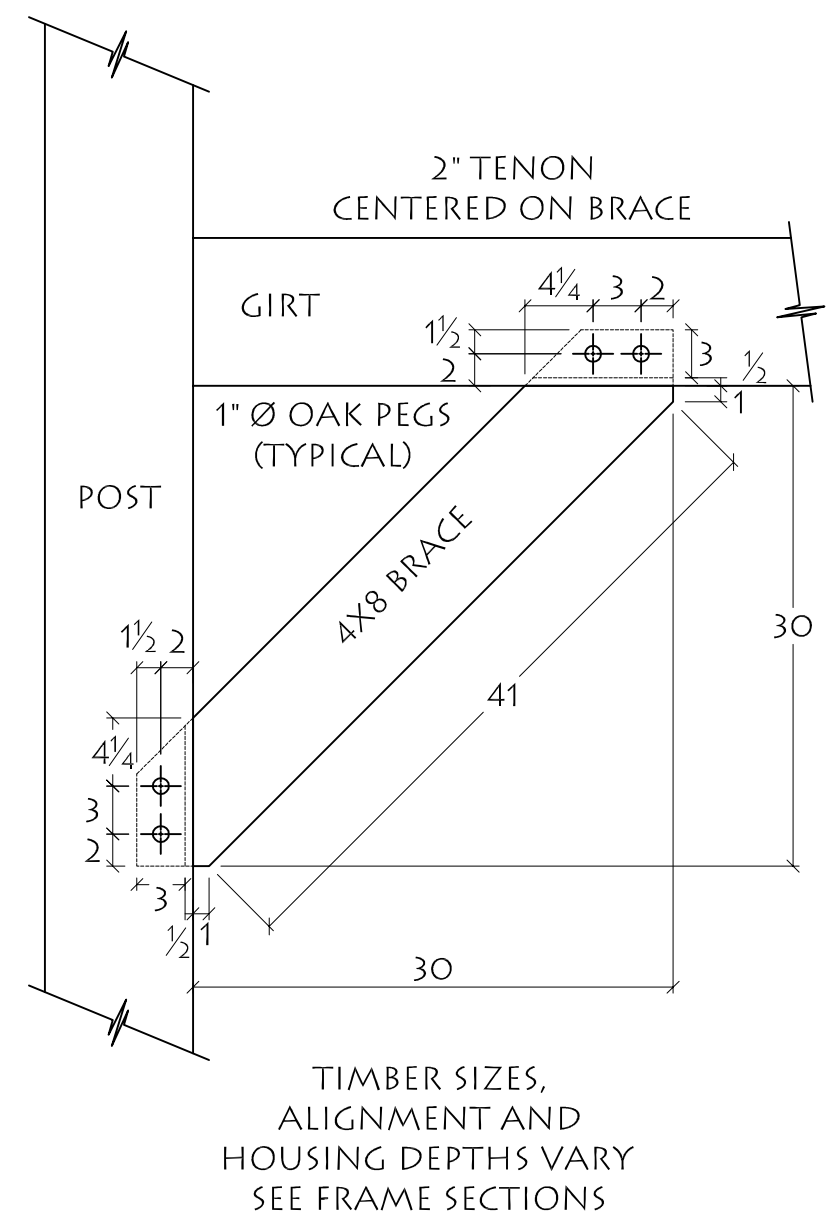

35 30" BRACE  
1" = 1'-0"

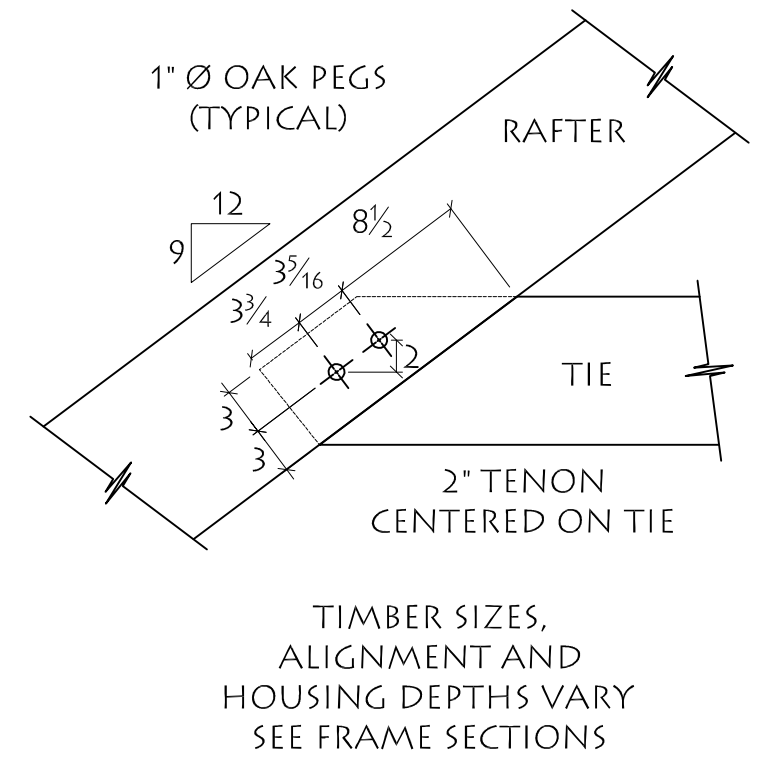

36 TIE AT RAFTER  
1" = 1'-0"

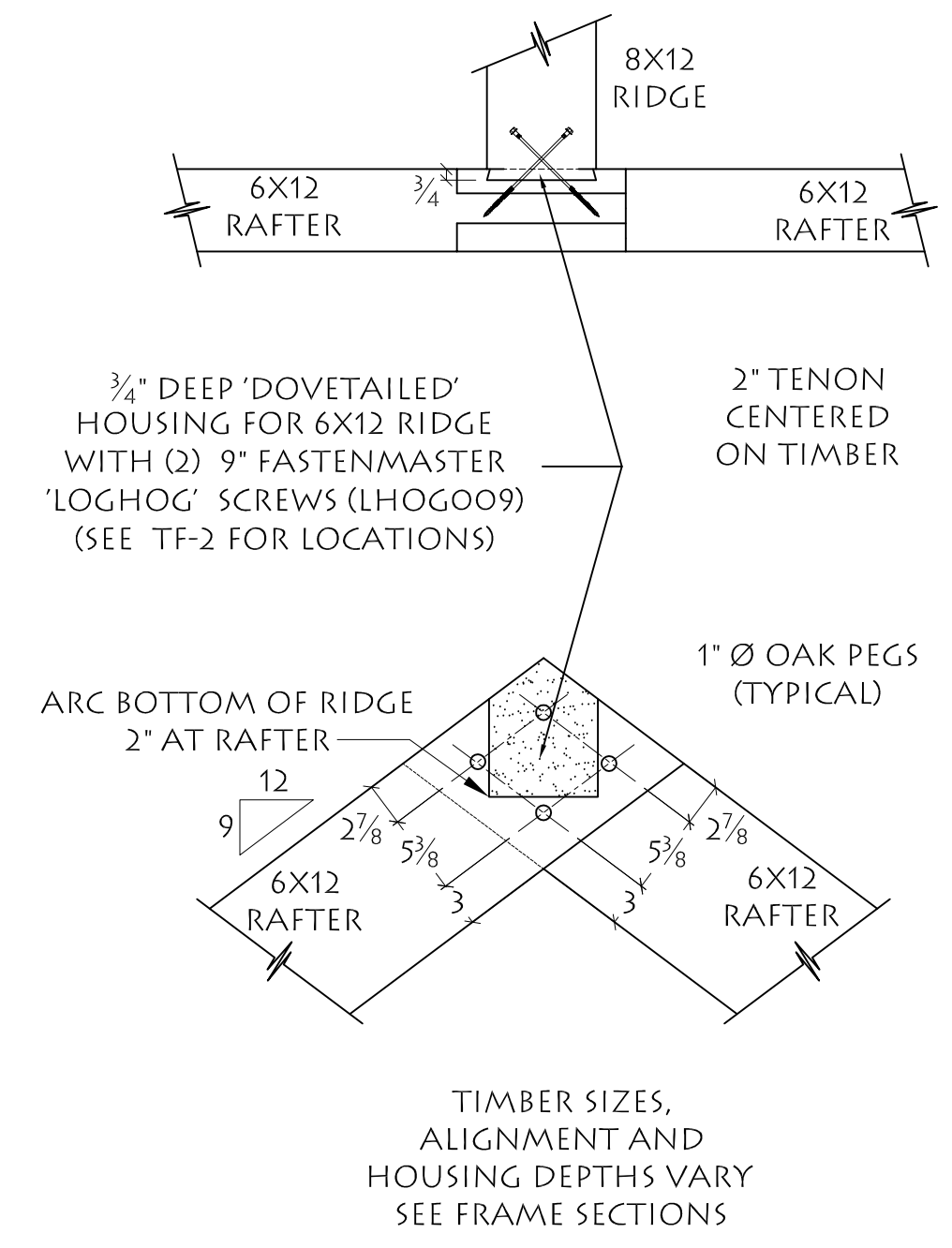

37 RAFTERS AND RIDGE  
1" = 1'-0"

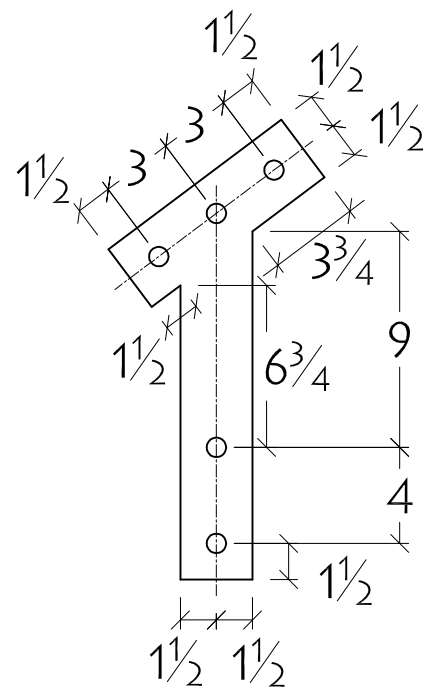

1/4" STEEL PLATE WITH 13/16" Ø DRILLED HOLES  
( 4 REQUIRED )

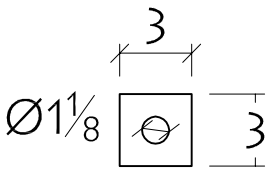

3/8" STEEL PLATE WITH 1 1/8" Ø DRILLED HOLES  
( 2 REQUIRED )

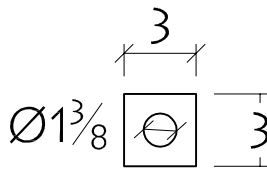

3/8" STEEL PLATE WITH 1 3/8" Ø DRILLED HOLES  
( 1 REQUIRED )

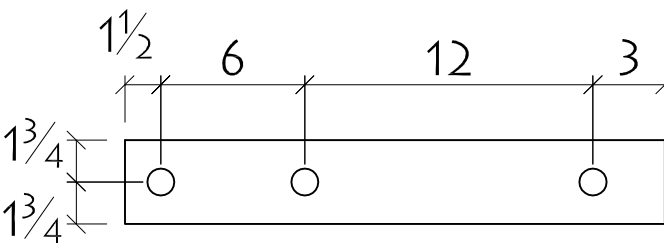
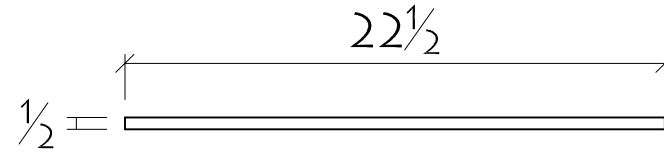

1/2" STEEL PLATE WITH 1 1/8" Ø DRILLED HOLES  
( 2 REQUIRED )

**D** PLATE D  
1 1/2" = 1'-0"

**E** PLATE E  
1 1/2" = 1'-0"

**F** PLATE F  
1 1/2" = 1'-0"

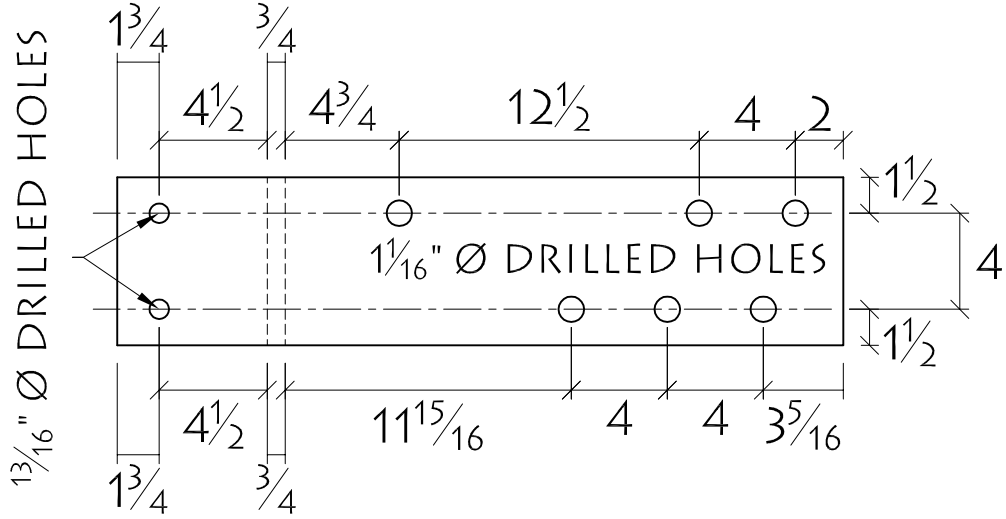
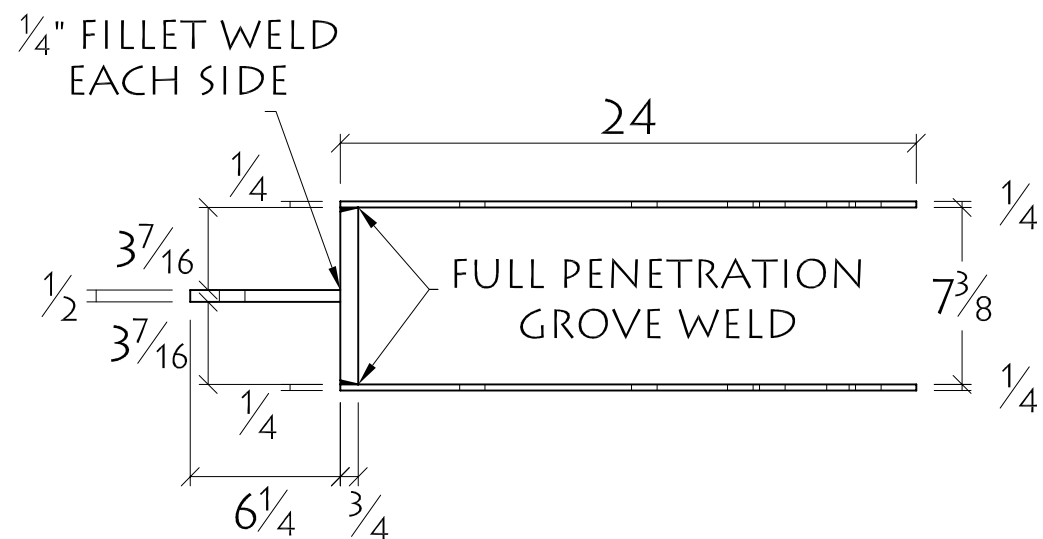

BENT 5 STEEL FIXTURES  
( 2 REQUIRED )

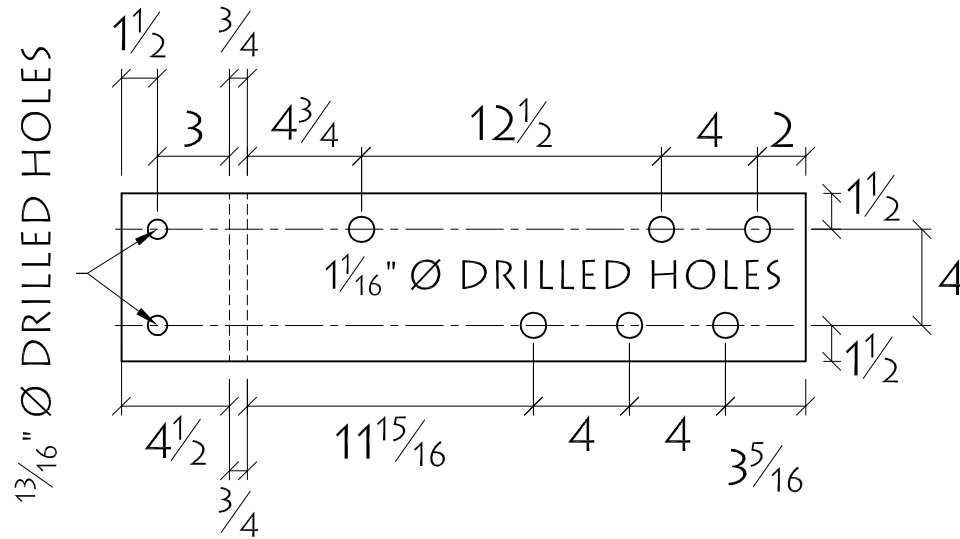
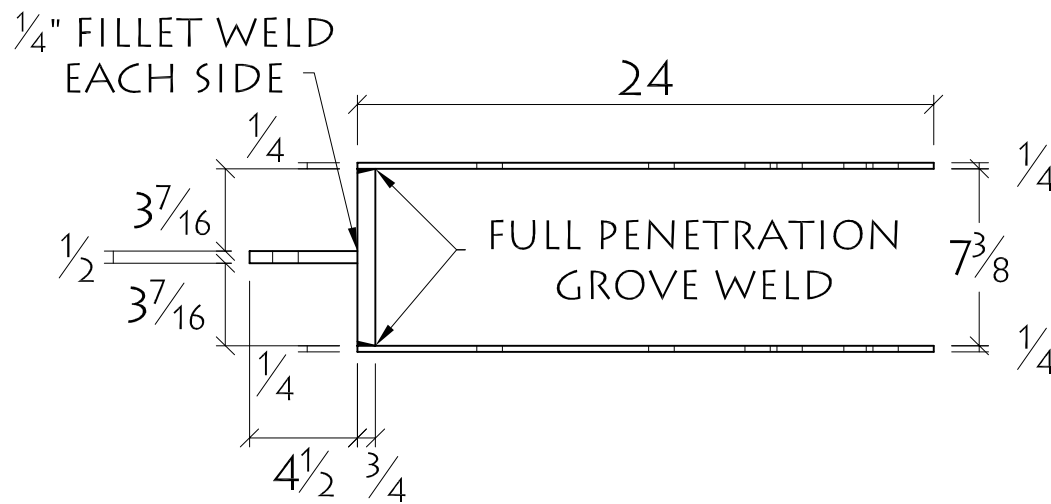

BENTS 6&8 STEEL FIXTURES  
( 4 REQUIRED )

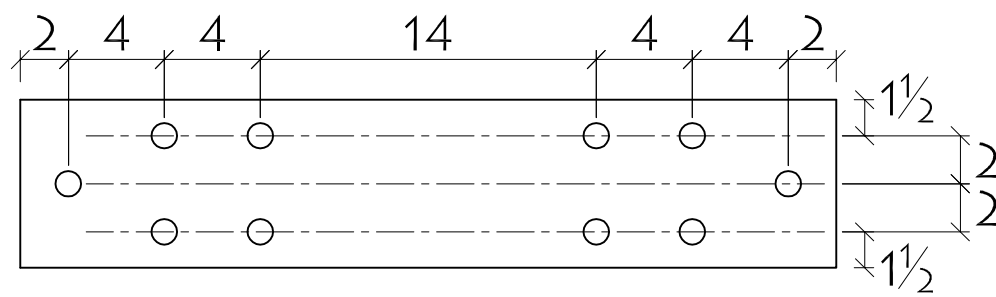
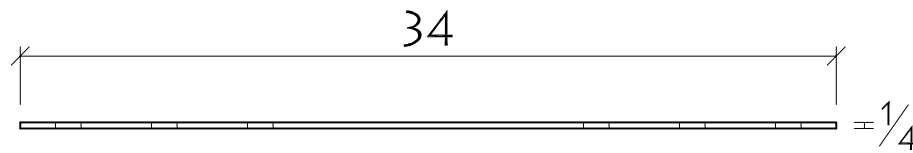

1/4" STEEL PLATE WITH 1 1/8" Ø DRILLED HOLES  
( 2 REQUIRED )

**A** FIXTURE A  
1 1/2" = 1'-0"

**B** FIXTURE B  
1 1/2" = 1'-0"

**C** PLATE C  
1 1/2" = 1'-0"

TIMBER FRAMED GARAGE

DELAWARE COUNTY, PA

REVISIONS

**NOTE:**  
THESE DOCUMENTS  
BEARING THE DATE  
06-05-12 SUPERCEDE  
AND SHALL REPLACE ALL  
PREVIOUSLY SUBMITTED  
DOCUMENTS FOR THIS  
PROJECT

DATE: 06-05-12

DRAWN BY: DFS

SHEET TITLE:  
JOINERY  
DETAILS

SHEET NUMBER:

ST-1